

E2005H00-NPX-L-HF-XX

- ① Series No.
- ② H90 : Side Contact  
H00 : Up Contact
- ③ No. of Circuits
- ④ X : Product color(A--Y)  
Blank : Natural type
- ⑤ L : Lock
- ⑥ HF : Halogen Free
- ⑦ NK : No Mark  
Blank : Mark

Specifications:  
 Rated Voltage : 250V AC/DC  
 Rated Current : 2A AC,DC  
 Withstand Voltage : 800V AC/minute  
 Contact Resistance : 20mΩ(MAX.)  
 Insulation Resistance : 1000MΩ(MIN.)  
 Temperature Range : -25°C~+85°C

Material :  
 Insulator: Nylon66 UL 94V-0

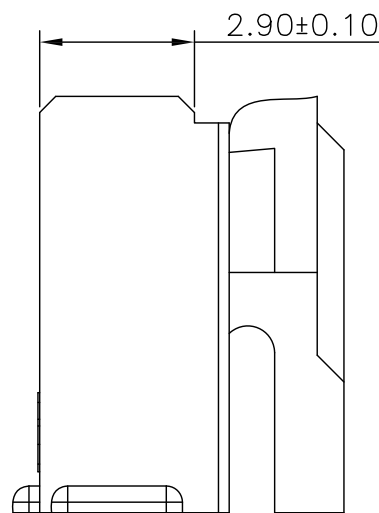
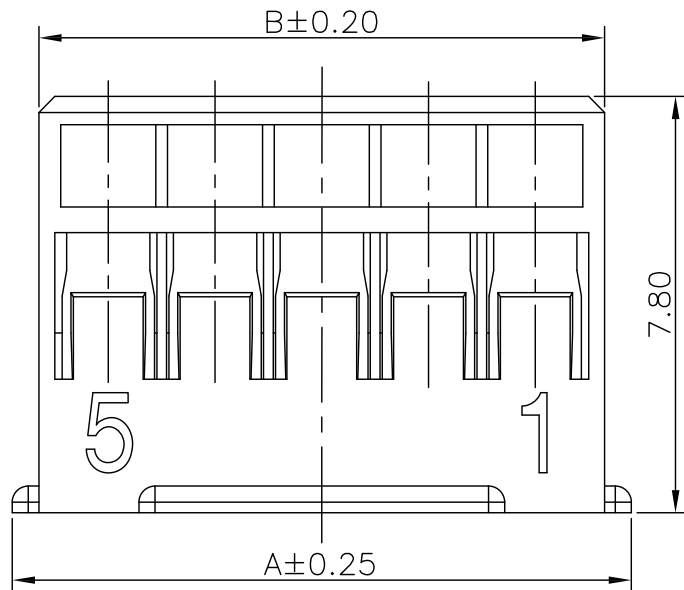

Dimensional Ordering Information				
Circuits Part No	Dimensions			
	A	B	C	D
2P	5.60	4.60	2.00	2.30
3P	7.60	6.60	4.00	2.30
4P	9.60	8.60	6.00	4.30
5P	11.60	10.60	8.00	6.50
6P	13.60	12.60	10.00	6.50
7P	15.60	14.60	12.00	6.50
8P	17.60	16.60	14.00	6.50
9P	19.60	18.60	16.00	6.50
10P	21.60	20.60	18.00	14.50
11P	23.60	22.60	20.00	14.50
12P	25.60	24.60	22.00	14.50
13P	27.60	26.60	24.00	14.50
14P	29.60	28.60	26.00	14.50
15P	31.60	30.60	28.00	14.50
16P	33.60	32.60	30.00	14.50

由 Autodesk 教育版产品制作

由 Autodesk 教育版产品制作

				GENERAL TOLERANCE		UNIT: mm		DATE		TITLE:		
				.X±0.25	X°±1°	DRAWN: 张自豪		2014.05.09		YH2.0 Housing		
				.XX±0.15	.X°±	CHECKED:				VER. SCALE: N/A		
				.XXX±0.10	.XX°±	APPROVED:				A1 SHEET: 1/1		
LTR	NAME	DATE	VERSION RECORD						PROJECT PART NO. E2005H00-NPX-L-HF-XX			
										DRAWING NO. E2005H-L		

东莞市宏欣蓝电子有限公司

A

B

由 Autodesk 教育版产品制作

E

F

A

B

由 Autodesk 教育版产品制作

E

F

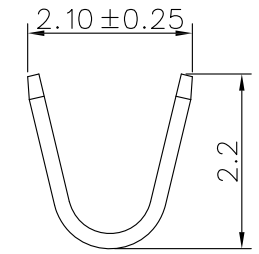
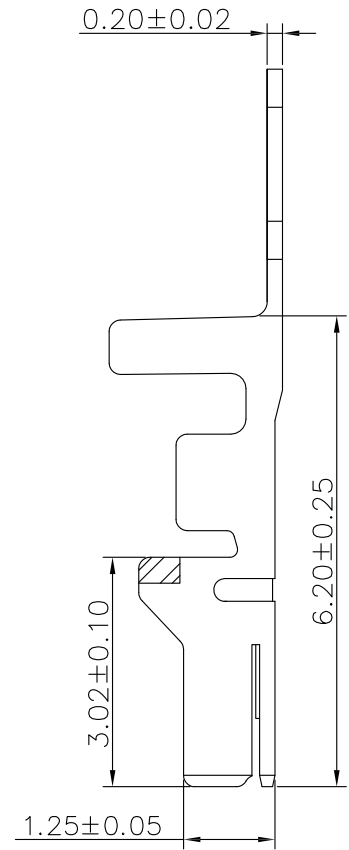
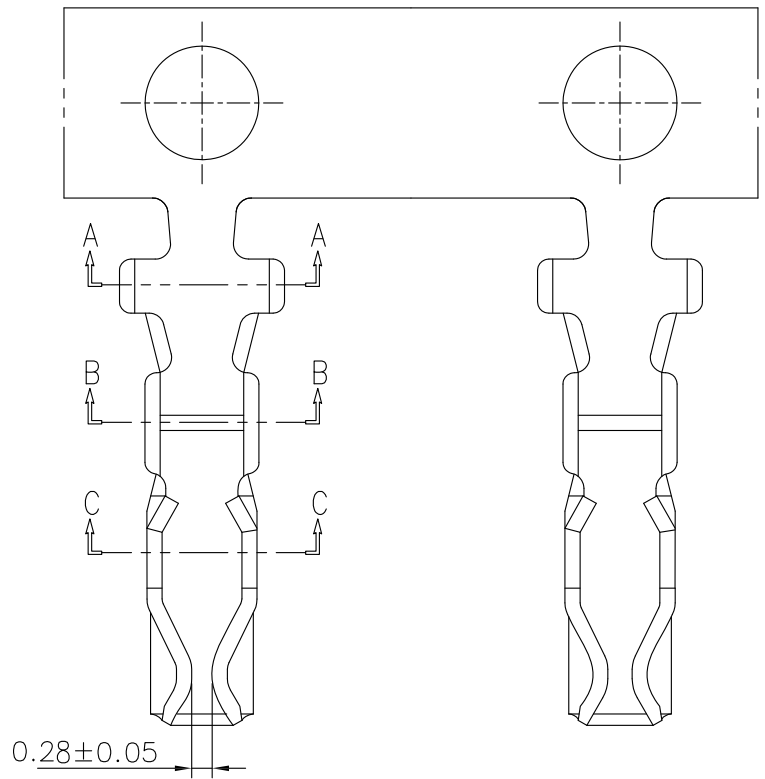

SECTION A-A

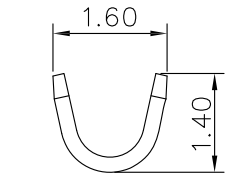

SECTION B-B

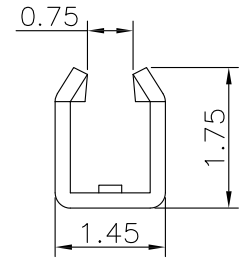

SECTION C-C

E2005TOP-XX-XX

NK: No Mark  
 Finish  
 2--Tin-plated(先镀后冲)  
 2E--Tin-plated(先冲后镀)  
 Phosphor Bronze  
 外观形态:180° Terminal

Part No	Wire Range	Insulation O.D.	Material	Finish	Qty/reel
E2005TOP-2	AWG#24~#28	1.60mm(max)	Phosphor Bronze	Tin-plated 60u"Min	10,000 pcs
E2005TOP-2E	AWG#24~#28	1.60mm(max)	Phosphor Bronze	Tin-plated 60u"Min	10,000 pcs

GENERAL TOLERANCE				UNIT: mm		DATE		TITLE:		
.X ± 0.25	X° ± 1°	DRAWN:	张自豪	2014.05.16		YH2.0 Terminal				
.XX ± 0.15	.X° ±	CHECKED:				VER.	SCALE:	N/A		
.XXX ± 0.08	.XX° ±	APPROVED:				A1	SHEET:	1/1		

东莞市宏欣蓝电子有限公司

PROJECT	PART NO.	E2005TOP-XX-XX
DRAWING NO.		E2005TOP

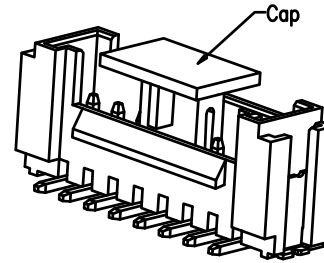
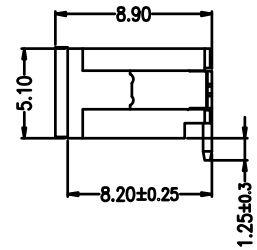
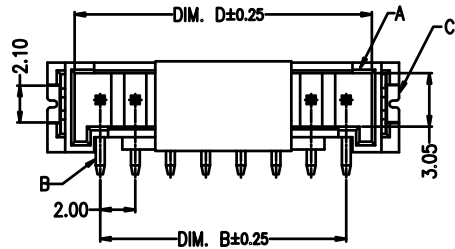

◆ SPECIFICATIONS

- Current rating: 3A AC, DC
- Voltage rating: 250V AC, DC
- Temperature range: -25°C ~ +85°C
- Insulation resistance: ≥1000MΩ
- Withstanding voltage: 1000V AC/ minute
- Contact resistance: ≤30mΩ
- After environmental testing: ≤40mΩ

Material:

- Insulator: LCP 94V-0
- Contact: Brass
- Plating: Tin plated over Nickel
- Mates with E2005 series housing

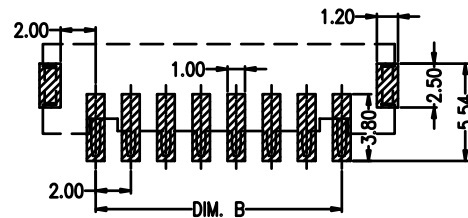
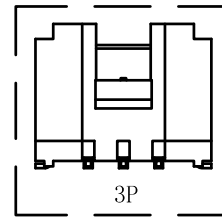
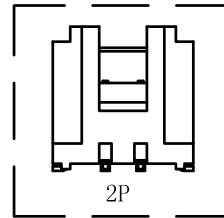
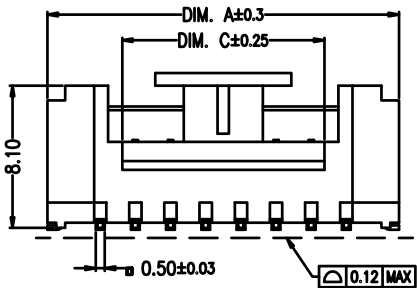

**SUGGESTED PCB LAYOUT**

Ordering code:

E2005W00-NP-S X X X XX -L  
 ①②③④⑤

- ① N=Halogen Free R=RoHS
- ② Material: 9=Nylon 6T L=LCP
- ③ Color: B=Black E=Beige
- ④ Plating code: T1=Tin plated  
G1=Gold-flash
- ⑤ L: Locking

Circuits	Dimensions (mm)			
	DIM. A	DIM. B	DIM. C	DIM. D
02	8.00	2.00	2.70	4.75
03	10.00	4.00	3.20	6.75
04	12.00	6.00	3.50	8.90
05	14.00	8.00	5.50	10.90
06	16.00	10.00	7.50	12.90
07	18.00	12.00	9.50	14.90
08	20.00	14.00	11.50	16.90
09	22.00	16.00	13.50	18.90
10	24.00	18.00	15.50	20.90
11	26.00	20.00	15.50	22.90
12	28.00	22.00	15.50	24.90
13	30.00	24.00	15.50	26.90
14	32.00	26.00	15.50	28.90
15	34.00	28.00	15.50	30.90
16	36.00	30.00	15.50	32.90

④				GENERAL TOLERANCE	UNIT: mm	DATE	TITLE:	
③				.X ± 0.30	X° ± 1°	DRAWN: 朱佑武	YH2.0mm SMT 180° Wafer	
②				.XX ± 0.20	.X° ±	CHECKED: 张自豪	VER. SCALE: N/A	
①				.XXX ± 0.10	.XX° ±	APPROVED: 张自豪	A SHEET: 1/1	
LTR	NAME	DATE	VERSION RECORD					

东莞市宏欣蓝电子有限公司

PROJECTION PART NO. E2005W00-NP-SRLET1-L



DRAWING NO. E2005W00-L

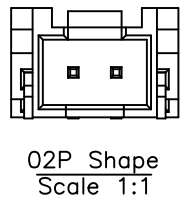
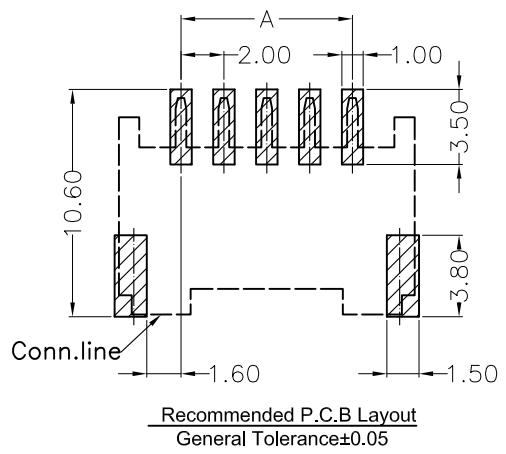
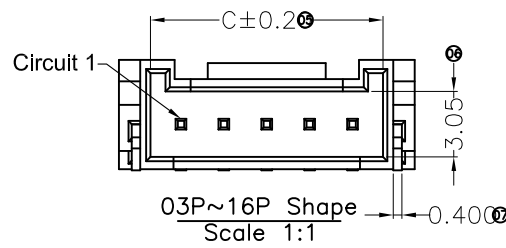
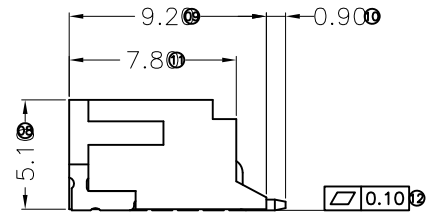
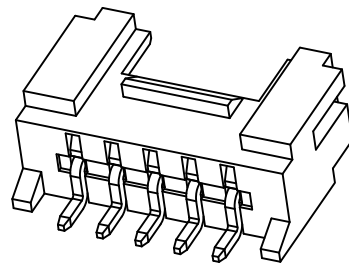
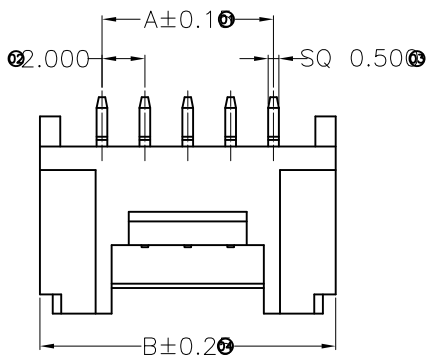

Specifications :  
 Voltage rating: 250V AC / DC  
 Current rating: 3A AC / DC  
 Withstanding voltage: 1000V AC/minute  
 Temperature range: -25°C~+85°C  
 Insulation resistance: ≥1000MΩ  
 Contact resistance: ≤30mΩ  
 After environmental testing: ≤40mΩ

Material:  
 Insulator: LCP UL94V-0  
 Contact: copper alloy  
 Finish: Tin plated over Nickel  
 Mates With E2005 Series Housing

Ordering code:  
 E2005W90-NP-S X X X XX -L  
 ①②③④⑤

- ① N=Halogen Free R=RoHS
- ② Material: 6=Nylon 6T L=LCP
- ③ Color: B=Black E=Beige
- ④ Plating code: T1=Tin plated  
G1=Gold-flash
- ⑤ L: Locking

Poles	Dimensions (mm)			Poles	Dimensions (mm)		
	A	B	C		A	B	C
02	2.00	7.80	4.85	10	18.00	23.80	20.85
03	4.00	9.80	6.85	11	20.00	25.80	22.85
04	6.00	11.80	8.85	12	22.00	27.80	24.85
05	8.00	13.80	10.85	13	24.00	29.80	26.85
06	10.00	15.80	12.85	14	26.00	31.80	28.85
07	12.00	17.80	14.85	15	28.00	33.80	30.85
08	14.00	19.80	16.85	16	30.00	35.80	32.85
09	16.00	21.80	18.85				

F	④			GENERAL TOLERANCE	UNIT: mm	DATE	TITLE: YH 2.00 SMT 90° Wafer			东莞市宏欣蓝电子有限公司		
	③			.X±0.30	X°±1°	DRAWN: 闵昕皓 2017.03.27						
	②			.XX±0.20	.X°±	CHECKED:	PROJECTION	PART NO.	E2005W90-NP-SRLET1-L			
	①			.XXX±0.10	.XX°±	APPROVED: 张自豪 2017.03.27	VER. A1	SCALE: 1/1	N/A	DRAWING NO.	E2005W90-L	
	LTR	NAME	DATE	VERSION RECORD								
	1	2	3	4	5	6	7	8	9			